



**PERKINS —  
EASTMAN**

Photo courtesy of TripAdvisor



# DENNIS-YARMOUTH SCHOOL PROJECT

THE DYIMS SCHOOL BUILDING  
COMMITTEE

July 11, 2018



# PROJECT TIMELINE

2017

## FEASIBILITY STUDY (PDP & PSR) HIGHLIGHTS

- SC Approves Educational Plan & Initial space Summary
- SBC Approves Ed. Plan & ISS
- SBC Approves PDP Alternatives
- SBC Approves PDP

2018

## FEASIBILITY STUDY (PDP & PSR) HIGHLIGHTS

- PDP Submit to MSBA **(11.15.17)**
- SBC Approves PSR
- PSR Submit to MSBA **(5.10.18)**

## SCHEMATIC DESIGN HIGHLIGHTS

- MSBA FAS Meeting **(05.23.18)**
- MSBA Board Meeting - Approved PSR **(6.27.18)**
- SBC Meeting to Review Costs
- SBC Approval of SD
- SD Submitted to MSBA **(10.17.18)**
- Town Meeting on Scope & Budget **(TBD)**
- Town-Wide Debt Exclusion Vote on Project Scope & Budget **(TBD)**
- MSBA Approves SD at Board Meeting **(12.12.18)**

YOU ARE  
HERE



2019

## DETAILED DESIGN (DDS & CDS) MILESTONES

- DDs Issued for Estimates
- DDs Submitted to MSBA
- 60% CDs Issued for Estimates
- 60% CDs Submitted to MSBA
- 90% CDs Issued for Estimates
- 90% CDs Submitted to MSBA
- 100% CDs Completed

## BIDDING/CONSTRUCTION MILESTONES

- Prequalify Filed Sub Trades
- Prequalify GC
- Advertisements & Bidding

2020  
-2022

## BIDDING/CONSTRUCTION MILESTONES

- New Building Construction
- Systems Commissioning
- Punchlist & Closeout
- Building Occupancy
- MSBA Audit/Closeout



# MSBA PROCESS

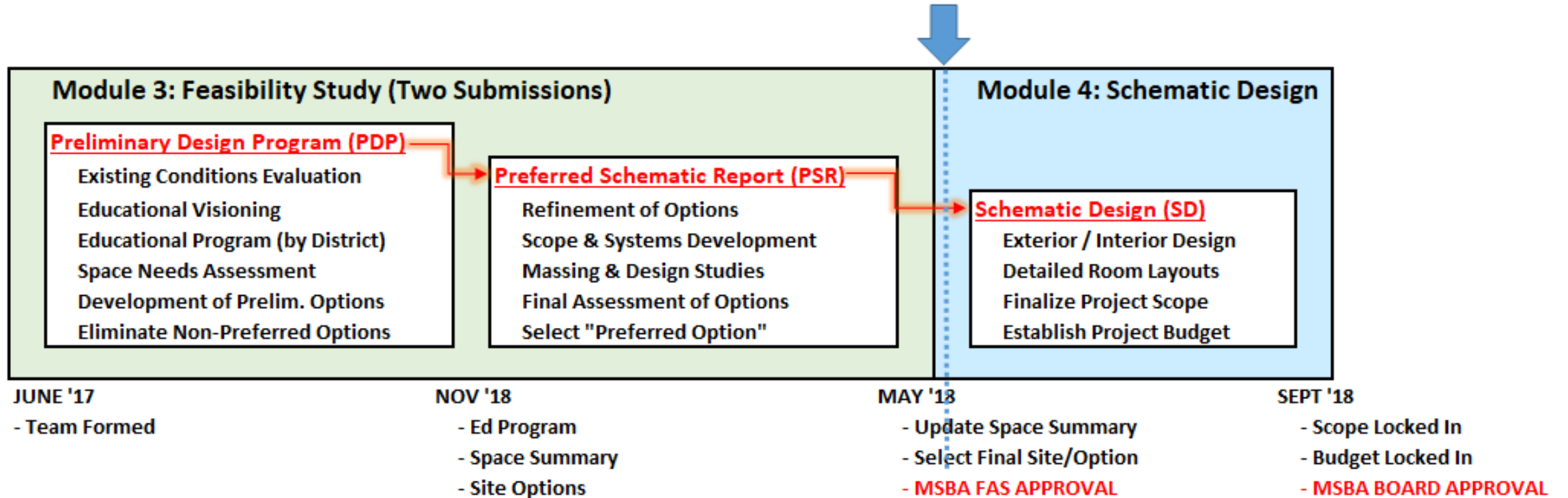

## KEY DATES: SBC

<i>June 27, 2018:</i>	<i>MSBA Board of Directors Meeting (Approval of Preferred Option)</i>
<b>July 11, 2018:</b>	<b>SBC Meeting (Plan Update, Exterior and Massing, Site Plan Update)</b>
<b>July 25, 2018:</b>	<b>SBC Meeting (Plan Update, Exterior Massing Update and Materials Presentation)</b>
<b>Aug 8, 2018:</b>	<b>SBC Meeting (Plan Update, Exterior and Massing Update and Materials Presentation, Interior Design – Major Spaces and Typical Classrooms, Site Plan Update, Room Layouts – Maker Spaces, Café, Music, Library with 3D images)</b>
<b>Aug 22, 2018:</b>	<b>SBC Meeting (Discuss SPED plan layout and spaces – Vote to Submit to DESE (for approval letter by 2/15/19), Plan Update, Exterior Elevations, Interior Design – Major Spaces and Typical Classrooms update, Energy Model Update, Room Layouts – Classroom, Corridors, Gym Etc. with 3D images)</b>
<b>Sept 12, 2018:</b>	<b>SBC Meeting (Check in/Final Questions/Clarifications for Pricing Set to Estimators)</b>
<b>Oct. 1, 2018:</b>	<b>Schematic Estimate Reconciliation</b>
<b>Oct 3, 2018:</b>	<b>SBC Meeting (Schematic Phase Value Engineering Due, If on Budget Vote Approval to Submit SD to MSBA)</b>
<b>Oct 17, 2018:</b>	<b>MSBA Deadline to Submit Schematic Design (SD)</b>
<b>Dec 12, 2018:</b>	<b>MSBA Board of Directors Meeting (Approval of Schematic Design &amp; Budget)</b>



# KEY DATES: WORKING GROUPS

<i>June 27, 2018:</i>	<i>MSBA Board of Directors Meeting (Approval of Preferred Option)</i>
<i>June 14, 2018:</i>	<i>Sustainability Workshop #1 Completed</i>
<i>6/19/18 &amp; 6/20/18:</i>	<i>Faculty and User Group Meetings Occurred at each school</i>
<i>7/10/18:</i>	<i>ELT Meeting Occurred</i>
<b>Week of 7/23/18:</b>	<b>Working Group Meeting (Technology Workshop – Data, Phone Infrastructure, PA System, Multi Media – V/A)</b> <b>Regulatory Agencies (Police, Fire, EMS)</b> <b>Working Group Meeting (Exterior Materials Palette Discussion)</b>
<b>Week of 8/6/18:</b>	<b>Sustainability Working Group (Continue Brainstorming integrated systems &amp; Envelope Options for EM/Cost, Examine increases R-value of roof/wall/slab (and what identifying point of HVAC down-sizing strategies), Renewable Energy sources and LEED Scorecard Update)</b>
<b>Week of 8/13/18:</b>	<b>Working Group Meeting (Interior Materials Palette Discussion)</b>

# GENERAL UPDATE

- *06/27/2018 MSBA Board approval to proceed into Schematic Design*
- Solar Array/PV Update
- SBC Membership Update
- Working Group Sign-Up
  - MEP
  - Interior
  - Exterior
  - Sustainability
  - Technical
  - Security (Police/Fire/EMS)
- School Committee Review of Funding Pathways Update

# DESIGN VISIONING





# SHORE





# MARSH





# FOREST

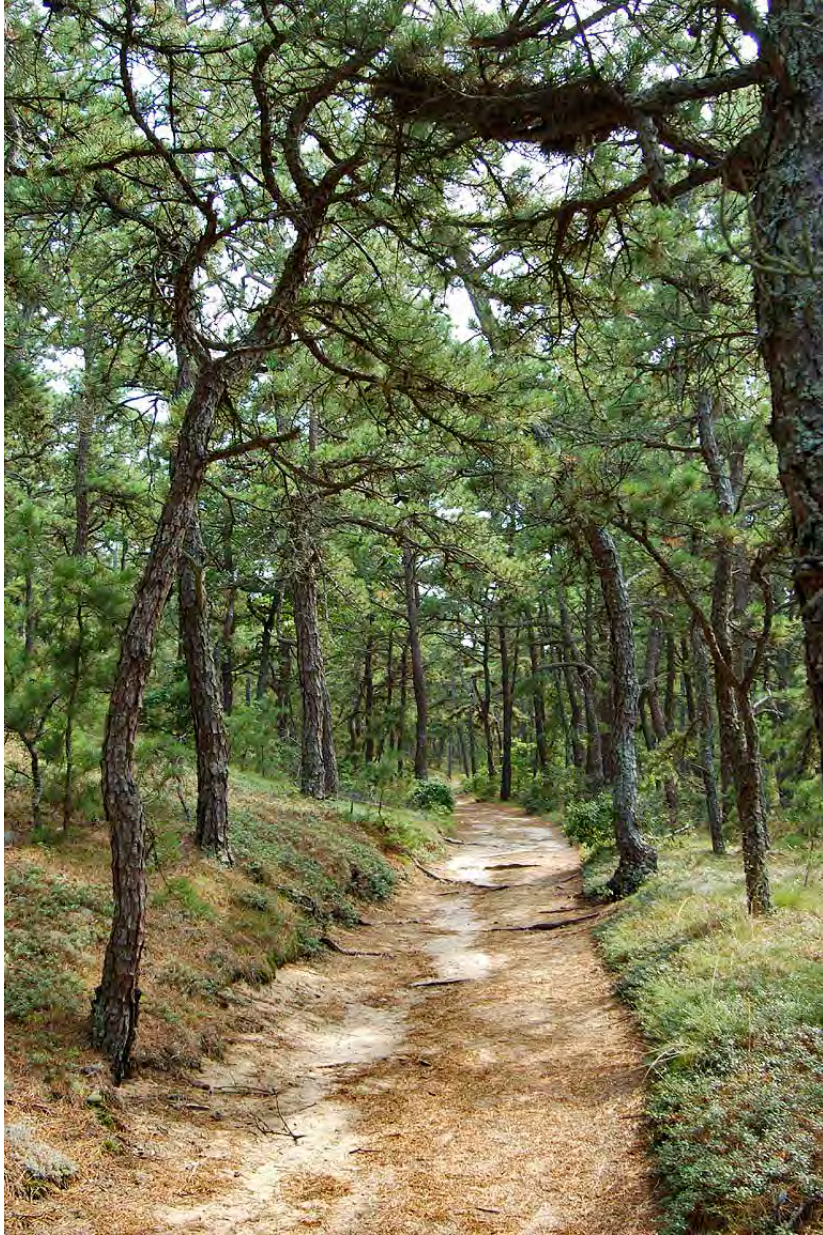



# LANDMARK





# ARCHITECTURAL CONTEXT



*United Methodist Church*  
S. Yarmouth, Massachusetts



*Dennisport Main Street*



*IFAW Headquarters*  
Yarmouthport, Massachusetts



# EXTERIOR MASSING

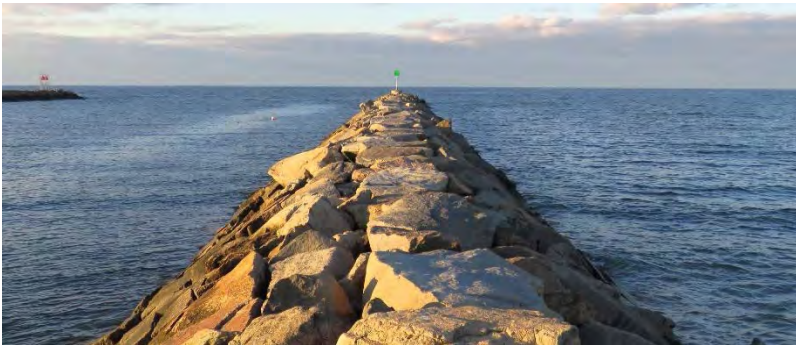



# EXTERIOR MASSING





# CIRCULATION

The entire plaza is handicap accessible. The center crosswalk connecting sidewalks from parking area to front plaza is raised to provide seamless crossing. Curb cuts will be provided. The site is relatively flat, and all travel paths will meet/exceed MAAB requirements.

➡ Mattacheese travel

➡ Wixon travel





# CIRCULATION

## Wixon Grades 4-5 at 1<sup>st</sup> Flr.

Note: 2 science rooms to be at 1<sup>st</sup> flr and 4 at 2<sup>nd</sup> flr. Specific locations to be further developed in SD.

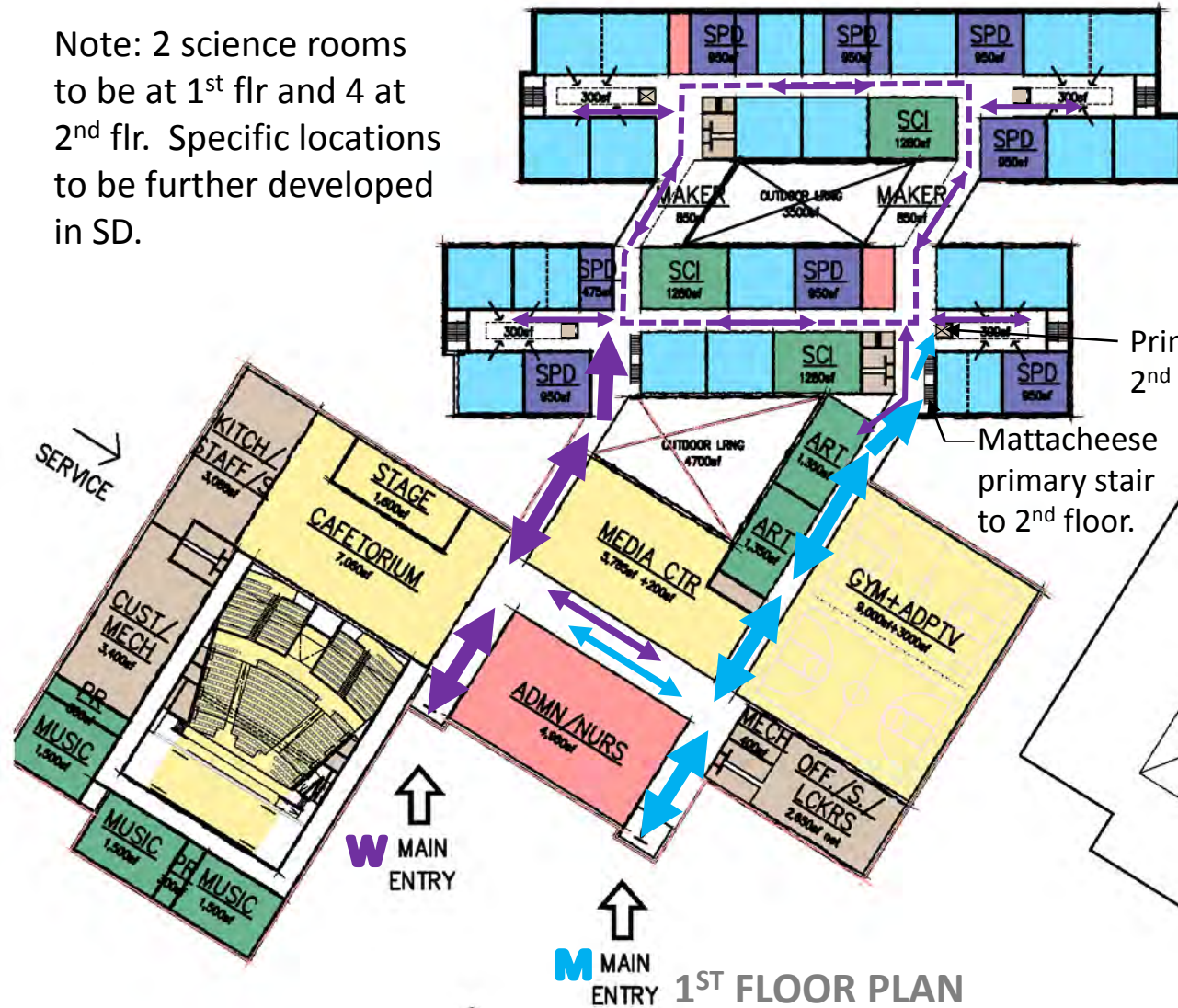

1<sup>ST</sup> FLOOR PLAN

## Mattacheese Grades 6-7 at 2<sup>nd</sup> Flr.

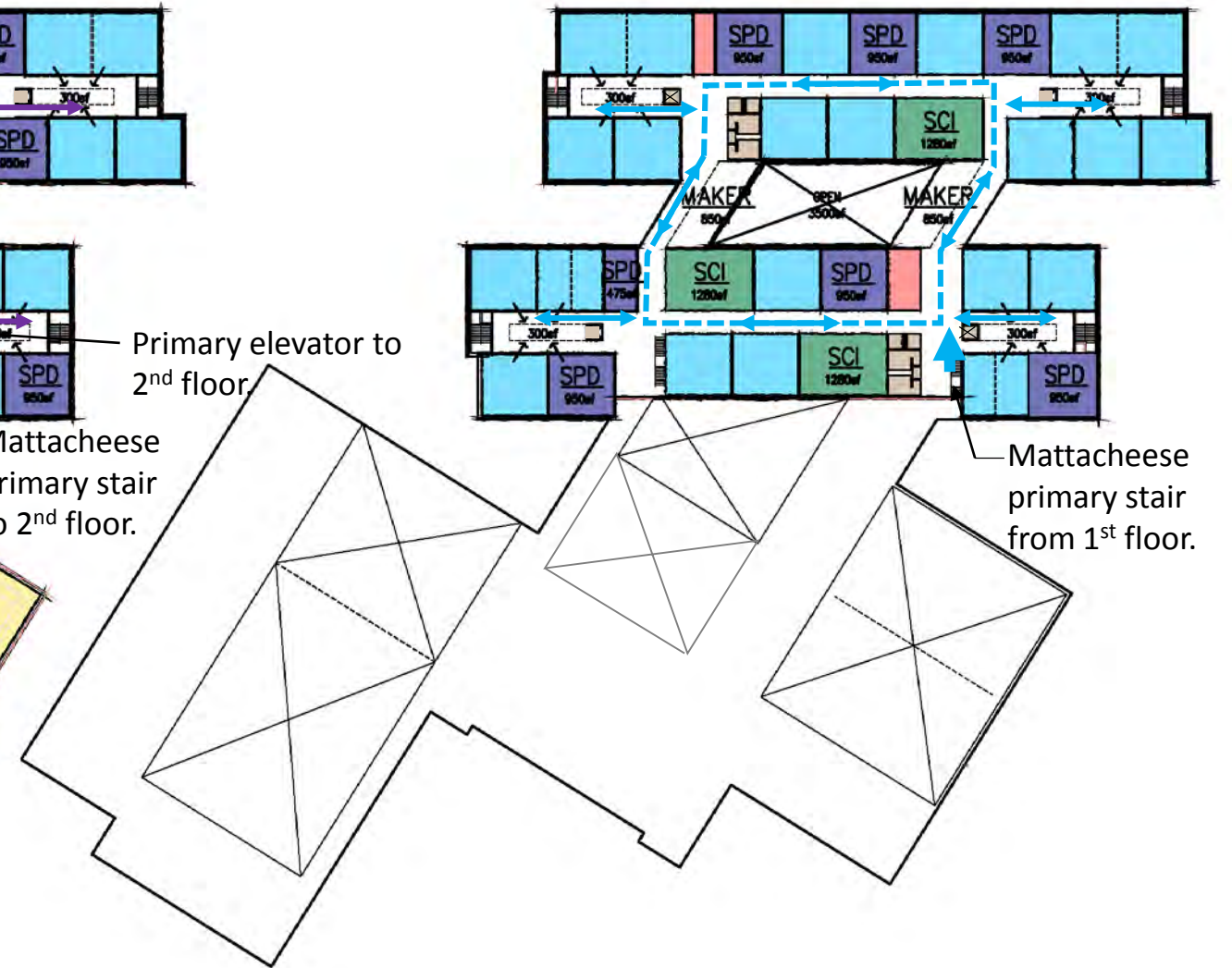

2<sup>ND</sup> FLOOR PLAN

# PLAN UPDATE

## First Floor Wixon

## Second Floor Mattacheese



### PROGRAM LEGEND

- ADMINISTRATION
- ART / MUSIC / TECH
- CLASSROOMS
- PUBLIC (GYM / CAF / MEDIA)
- SPECIAL EDUCATION
- STEM
- UTILITY / SUPPORT



# PLAN UPDATE

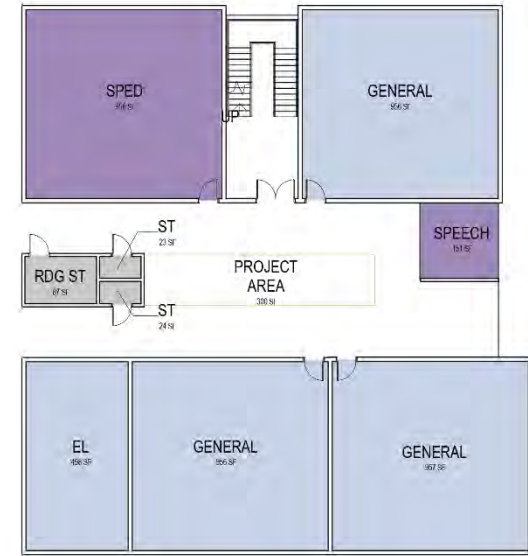
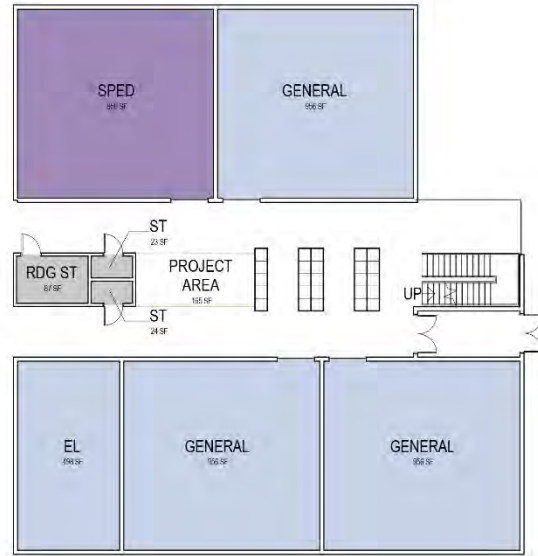

*Academic Cluster Exploration*



EXISTING CONDITIONS AT STATION AVENUE SITE AS EXAMPLES



TREES ALONG EDGES



SHRUBS ALONG EDGES



GROUNDCOVERS



SHADE WITHIN LAWN AREAS

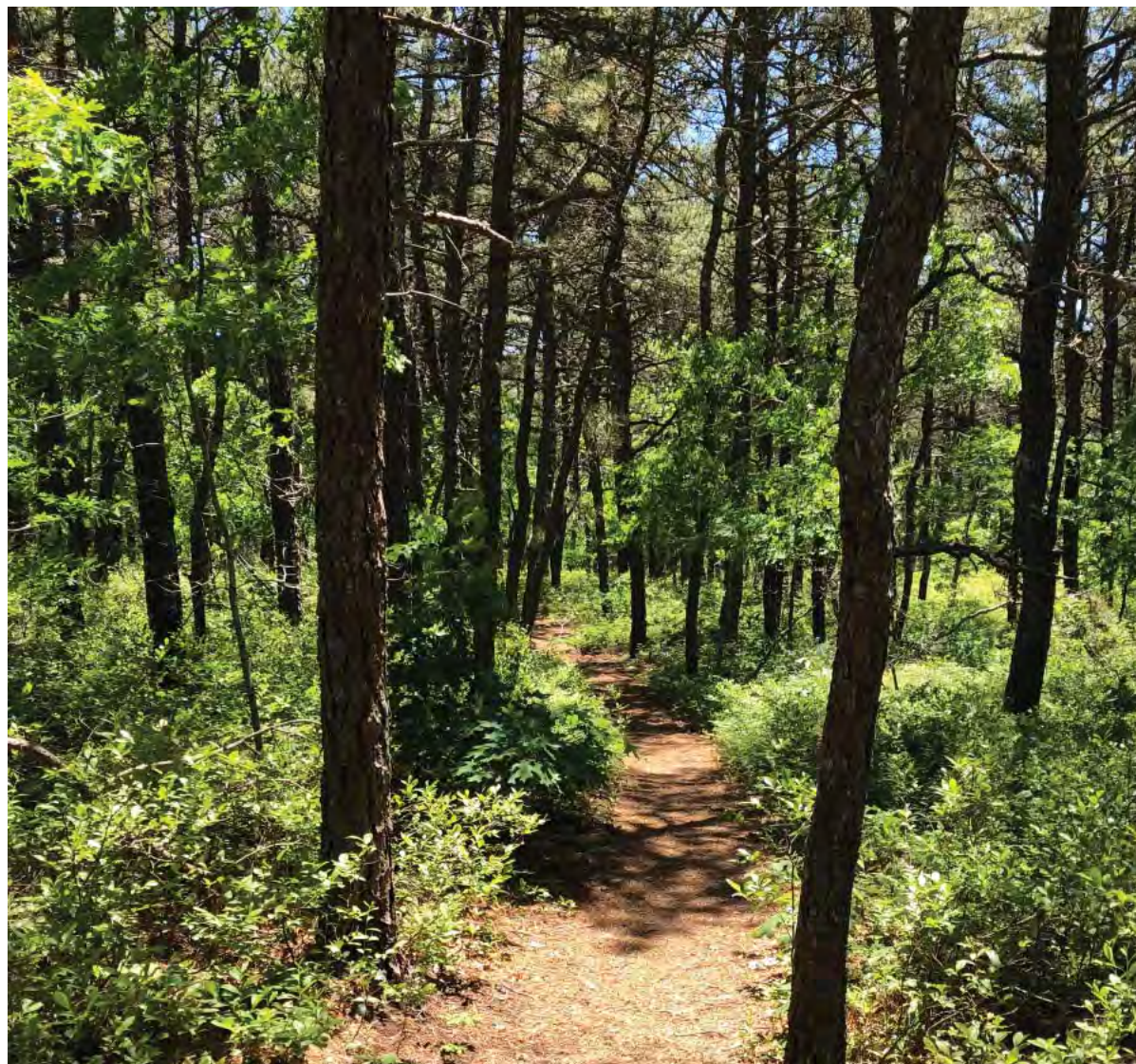

WOODLAND PATH

EXISTING OUTDOOR PROGRAMMING AND AMENITIES AT MATTACHEESE AND WIXON SITES



AMENITIES



ACTIVE PLAY



PERFORMANCE

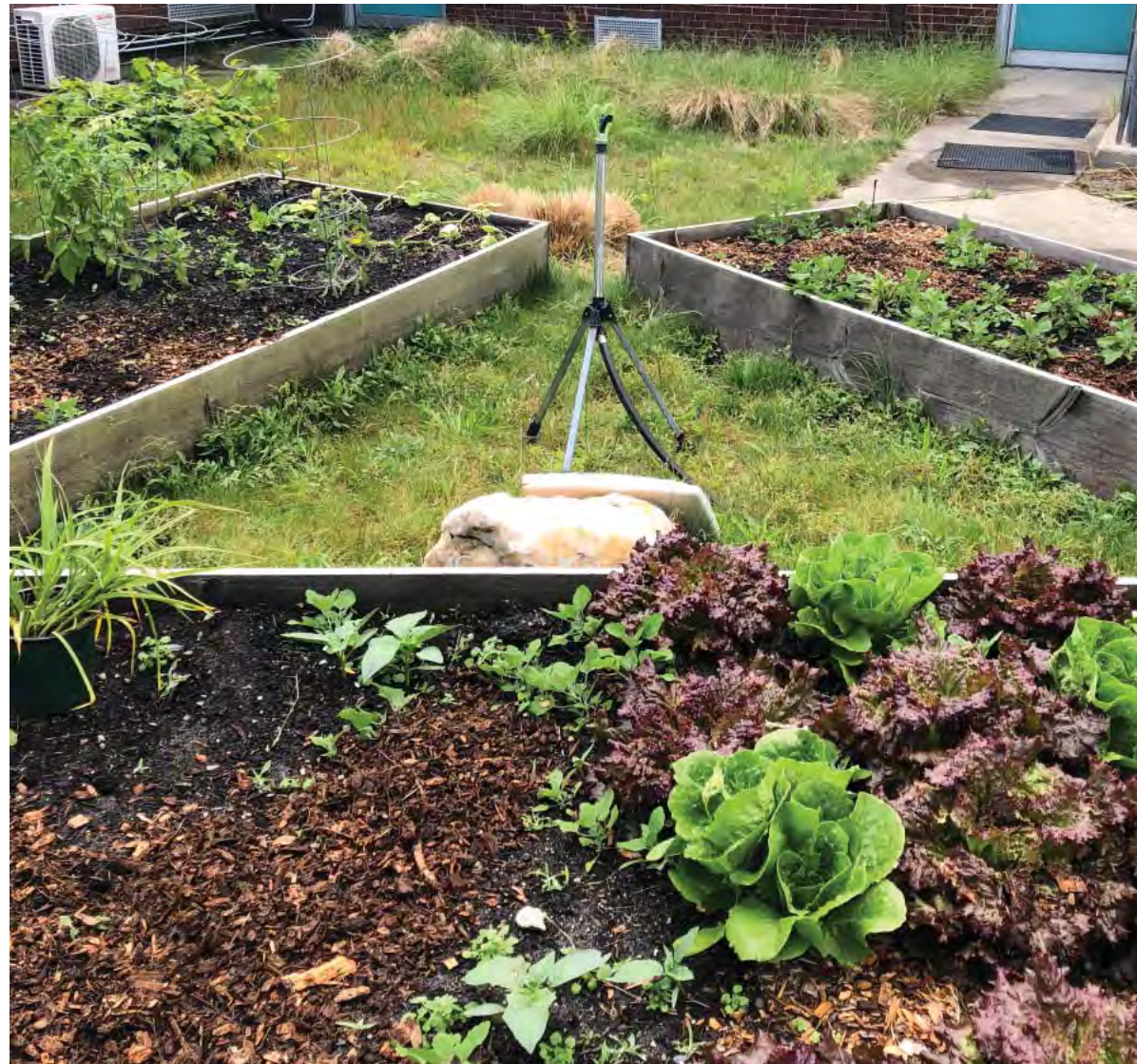

SCHOOL GARDENING



QUIET NOOKS

GUIDING PRINCIPALS FOR THE NEW DENNIS YARMOUTH REGIONAL DISTRICT MIDDLE SCHOOL SITE DEVELOPMENT

- 1. CREATE A SPECIALIZED LANDSCAPE INFLUENCED BY EXISTING SITE VEGETATION AND THE CAPE COD ECOLOGY
- 2. IMPROVE UPON THE EXISTING OUTDOOR PROGRAMMING WITH FLEXIBLE, FUNCTIONAL AND PLAYFUL SPACES
- 3. INTEGRATE THE NEW SCHOOL INTO THE ACADEMIC CAMPUS



# NATIVE PLANT PALETTE



NATIVE EVERGREEN TREES  
AND SHRUBS

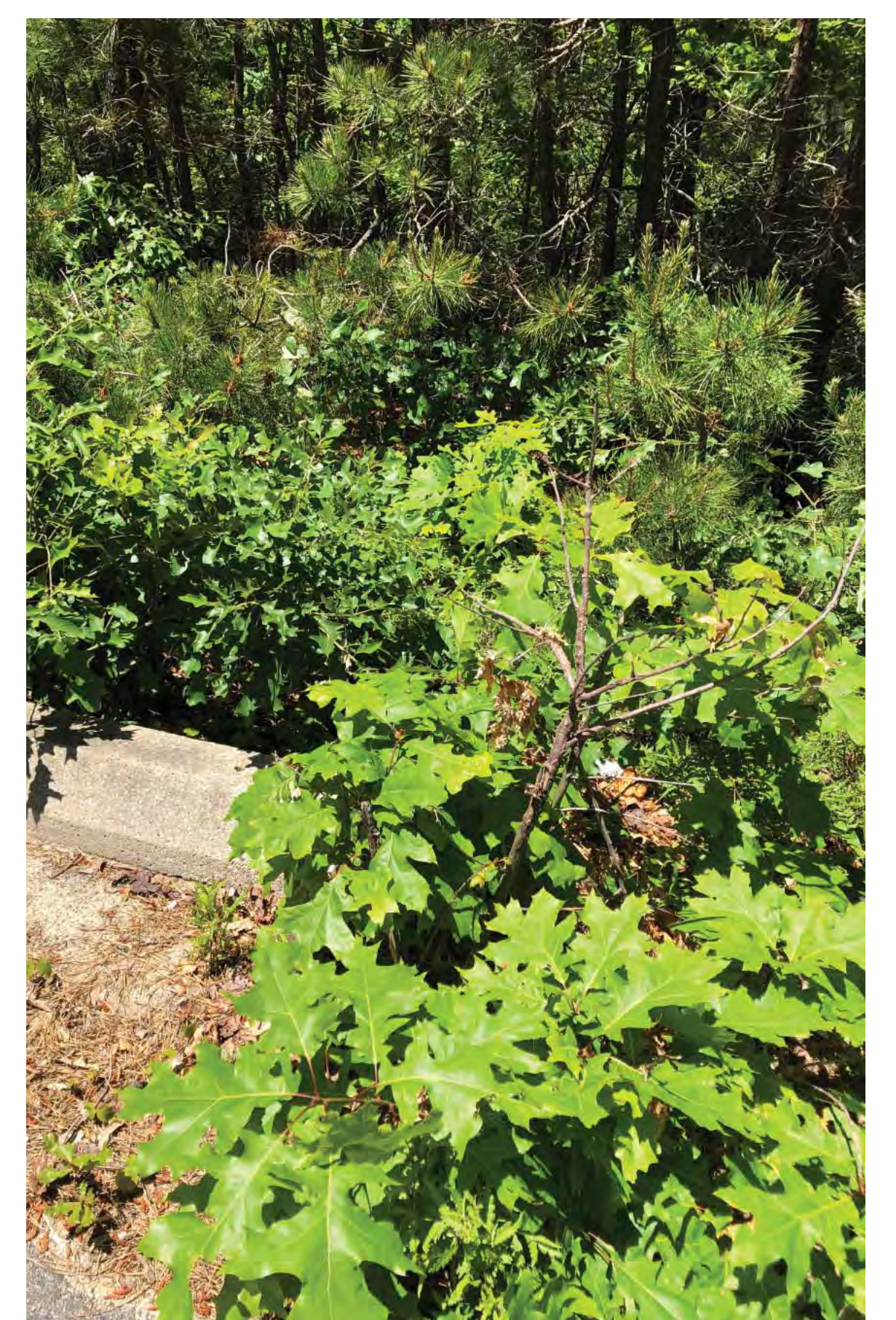
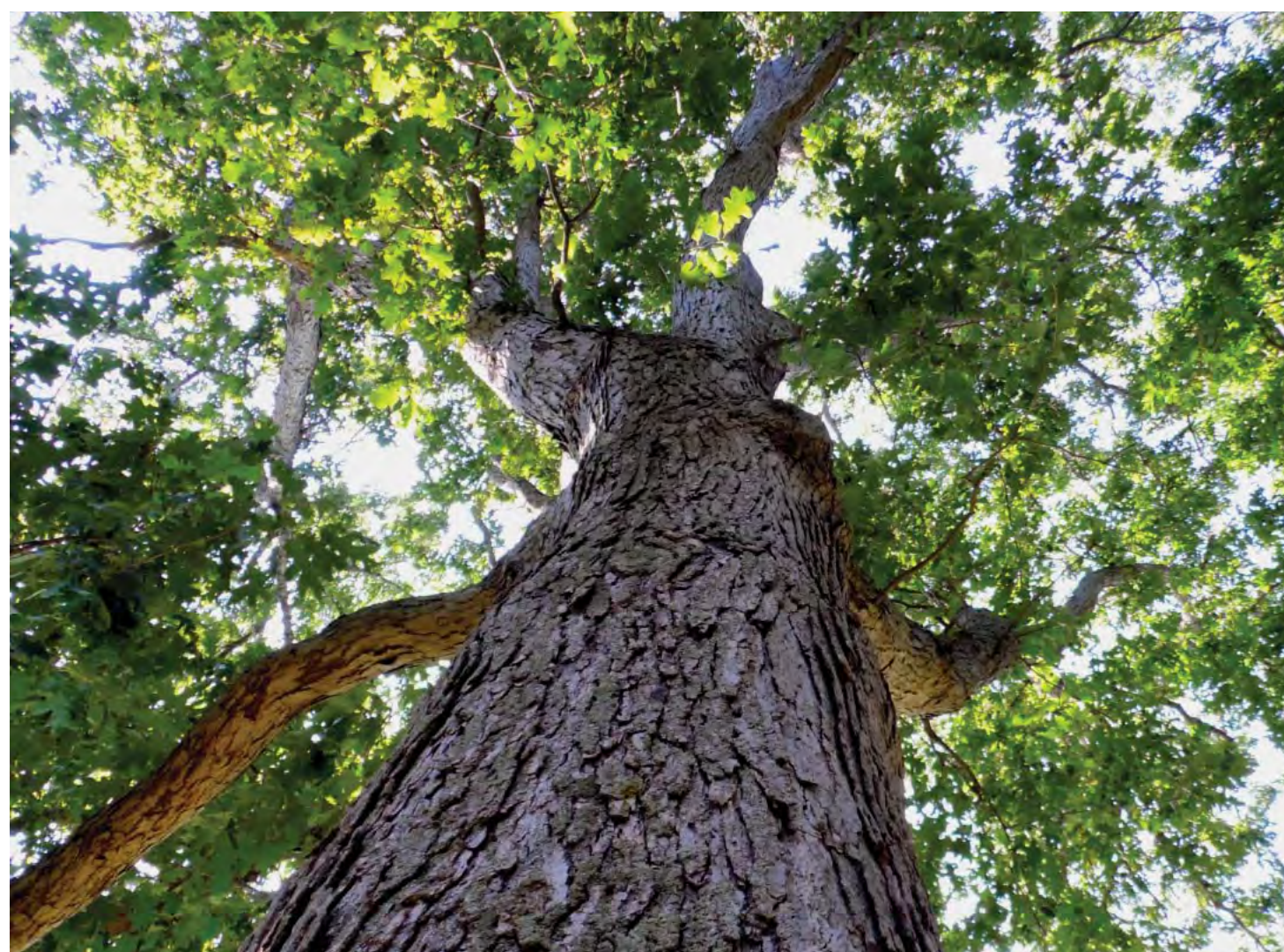

NATIVE DECIDUOUS TREES



NATIVE PLANT PALETTE



NATIVE SHRUBS PERENNIALS AND GROUNDCOVERS





LINEAR BIOSWALES WITHIN PARKING AREAS



LARGE RAIN GARDEN IN THE LANDSCAPE



SMALL RAIN GARDEN IN A COURTYARD



OUTDOOR PROGRAMMING

TO EXISTING TRAIL

TO NATURE TRAIL

TO EXISTING TRAIL

TO FIELDS

- COMMUNITY SPACE
- 4TH-5TH GRADE
- 6th-7th GRADE

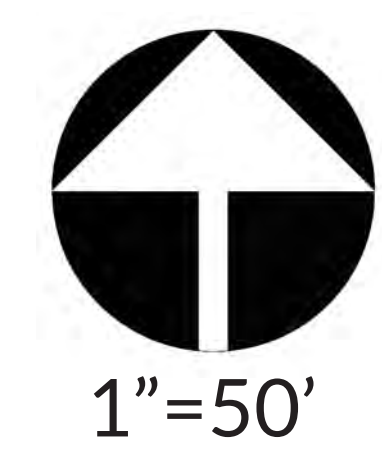



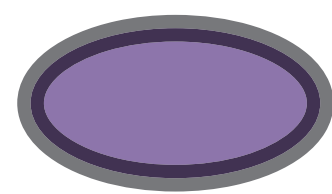

INDOOR/OUTDOOR VIEWS



GATHERING-PERFORMING SPACE



DEFINED CIRCULATION AND AMENITIES



NATIVE PLANTING BEDS



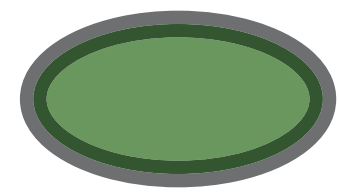

4TH-5TH GRADE



RAISED GARDEN BEDS AND WORK SPACE



STRUCTURED AND NATURAL PLAY



CLIMBING STRUCTURE



HARD SURFACE PLAY



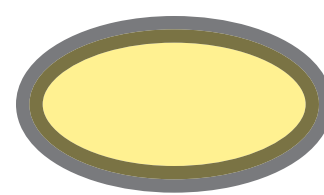

6th-7th GRADE



RAISED GARDEN BEDS



FITNESS



FITNESS



CLIMBING STRUCTURE  
WITH NOOKS



TABLE GAMES



HOOPS





**PERKINS —  
EASTMAN**

Photo courtesy of TripAdvisor



# DENNIS-YARMOUTH SCHOOL PROJECT

THE DYIMS SCHOOL BUILDING  
COMMITTEE

July 11, 2018

